

Cissell Mfg. Co.  
 831 S. First St. / P.O. Box 32270  
 Louisville, Ky. 40232-2270  
 PH. 502/587-1292  
 FAX 502/585-3625  
 www.cissellmfg.com



Cissell Mfg. Co.  
 831 S. First St. / P.O. Box 32270  
 Louisville, Ky. 40232-2270  
 PH. 502/587-1292  
 FAX 502/585-3625  
 www.cissellmfg.com

# The HD 75 On Premise Laundry Dryers



## FEATURE

CFM - 1000  
 Gas- 180,000 BTU  
 Steam - 5.9 BHP  
 Electric - 30 kW

Diagnostics - Optional

Safest Dryer Available

Rotational Sensor - Optional  
 Standard on OPL with DMP  
 Reed Switch - Exclusive

Emergency Stop Button - Exclusive  
 Lint Door Switch - Exclusive

24V Controls with Ignition System  
 Extended Sides/Enclosed Back

Full 75 lb. Capacity Extruded Basket

Belt Driven

Lint Screen

Stainless Steel Burners - Standard

Electrostatically Applied Powder Paint

## BENEFITS

Ideal balance between BTU and CFM for maximum efficiency and fast dry times

Allows operator or service technician to instantly diagnose problems

Detects broken belts

Magnetic door switch that stops the dryer when the door opens  
 Instantly shuts off dryer  
 Automatically shuts dryer down when lint door is open  
 Additional safety for operator  
 Additional safety for operator

No-snag, no-sag basket. Construction similar to washer extractor basket

Standard (Reversing Optional)

Nylon self-cleaning lint screen with snaps that make it easily removable

Increased efficiency / long burner life

Painted inside and out to prevent chipping and rusting

## Simple Microprocessor with diagnostics (DMP)



### Feature

- 1) 5 preset programs
- 2) On/Off Reversing button
- 3) Anti-wrinkle safety tumble
- 4) Temperature display
- 5) End of cycle buzzer
- 6) Extra contacts standard
- 7) Basket RPM display
- 8) Lint door monitor
- 9) Automatic diagnostic display

### Benefit

- Dryer can be installed and will work without programming.  
 Simply push button to activate or deactivate reversing action.  
 If door is not open at end of cycle dryer will tumble to remove any excess heat and at the same time prevent unnecessary wrinkling.  
 Simply push temperature button and hold and it will display the current basket temperature.  
 Alerts operator that the cycle is finished.  
 Allows a strobe light to be added for the hearing impaired. Meets Veteran Hospital specifications.  
 Simply push and hold the start button and it displays RPM's of basket. This helps maintenance workers determine if belts need to be tightened.  
 Alerts operator to clean the lint filter.  
 A) dor Indicates the loading door is in the open position  
 B) Ldr Indicates lint door switch is in the open position  
 C) cln Indicates lint filter needs to be cleaned  
 D) FSS Indicates a failure of the sail switch  
 E) -S- Indicates safety tumble mode  
 F) End End of Cycle

# CISSELL HD 75 DRYERS

AGA, CGA, CSA, and CE Approved

All specifications are subject to change without notice.

Specifications	U.S. Measure	Metric Measure	
Capacity (Dry Linen)	75 lb	34 kg	
Basket	Diameter	37 in / 940 mm	
	Depth	36 in / 914 mm	
	Volume	22.4 cu/ft / 634 liters	
Cabinet	Height	78-1/4 in / 1988 mm	
	Width	39 in / 990 mm	
	Depth	52 inch / 1321 mm	
Door Opening	Dia.	22-5/8 in / 575 mm	
	Loading height	35-1/2 in / 902 mm	
Temperature Micropro.	Min.	100° F / 38° C	
	Max.	185° F / 85° C	
Temperature Dual & Mech. Coin	Min.	135° F / 57° C	
	Max.	175° F / 79° C	
Motor	Non-Rev	3/4 HP / 0.56 kW	
	Reversing - Drum	1/2 HP / 0.37 kW	
	Fan	1/2 HP / 0.37 kW	
Fan Motor for Steam	1-1/2 HP	1.11 kW	
Exhaust	Flow Rate	1000 CFM / 1700 m³/hr	
	Diameter	8 inch / 203 mm	
	Steam Model	1200 CFM / 2038 m³/hr	
Recommended Air Supply Area	Min. 192 in²	1240 cm²	
<b>Electric Connections - Elec. Dryers</b>		Non-Reversing	Reversing
208 V	60 - 3 PH	89 Amp	88 Amp
220/240 V	50/60 - 3 PH	72/78 Amp	72/78 Amp
380/415 V	50 - 3 PH	44/48 Amp	43/46 Amp
480	60 - 3PH	38 Amp	39 Amp
<b>Elec. Conn. - Steam, Gas Dryers</b>		Non-Reversing	Reversing
120/208-240	50/60 - 1PH	10.6/5.4 Amp	
208/240 V	50/60 - 3 PH	4.2/4.1 Amp	5.5/5.4 Amp
380/415 V	50 - 3 PH	1.7/1.8 Amp	4.3/4.4 Amp
480 V	60 - 3 PH	1.6 Amp	2.5 Amp
Power	Gas Input	189,000 Btu/h / 47,627 kcal/h	
	Electric	30 kW / 25,800 kcal/h	
	Steam	5.9 BHP / 49,842 kcal/h	
Steam Max. Pressure	125 psi	8.6 bar	
Connection	Gas	1/2" / DN 15	
	Steam Inlet	3/4" / DN20	
	Steam Outlet	1/2" / DN 15	
Inlet Supply Pressure (Nat. Gas)		6" - 12" w.c. (15-30 mbar)	
Manifold Pressure -	Nat. Gas	3.5" w.c. (8.5 mbar)	
	LP Gas	11" w.c. (27 mbar)	
Shipping Dim. (H x W x D)	87 X 42 X 57 in	2210 X 1067 X 1448 mm	
Export Cube (Carton)	121 ft³	3.4 m³	
Weight	Net	798 lb / 362 kg	
	Gross	828 lb / 376 kg	



Authorized Distributor



Cissell Manufacturing Company  
 HEADQUARTERS  
 831 S. FIRST ST. - P.O. BOX 32270  
 LOUISVILLE, KY. 40232-2270  
 PH: 502/587-1292 \* FAX: 502/585-3625  
[www.cissellmfg.com](http://www.cissellmfg.com)



Cissell Mfg. Co.  
 831 S. First St. / P.O. Box 32270  
 Louisville, Ky. 40232-2270  
 PH. 502/587-1292  
 FAX 502/585-3625  
[www.cissellmfg.com](http://www.cissellmfg.com)

## HD 75 On Premise Laundry Dryers

### Classified Material

This drawing or diskette is submitted to you with the confidence that it will be used only for your information and application engineering studies and shall not be used in any manner detrimental to the interests of Cissell Manufacturing Co.

**Clearance: Top: 18" Recommended. 0" permitted for first 4" along front of machine. Back: 0" permitted. 36" recommended - Side: 0" permitted.**

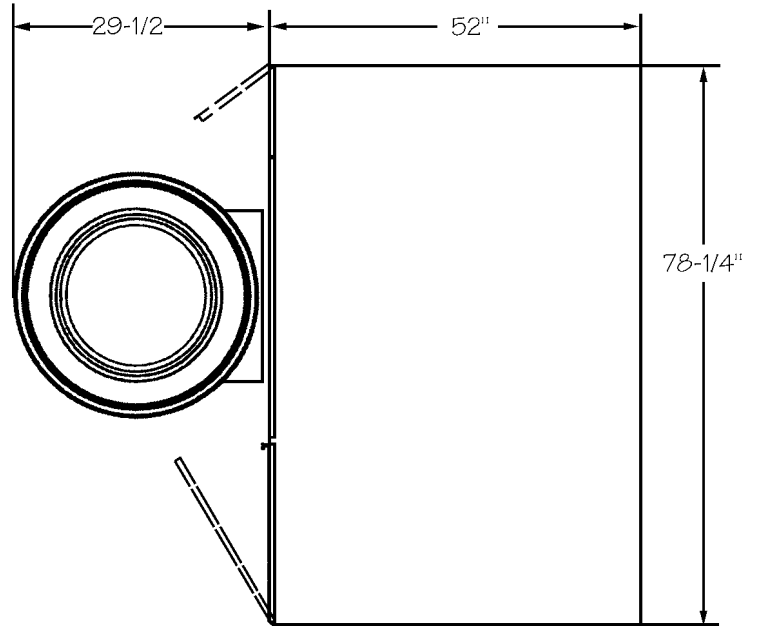
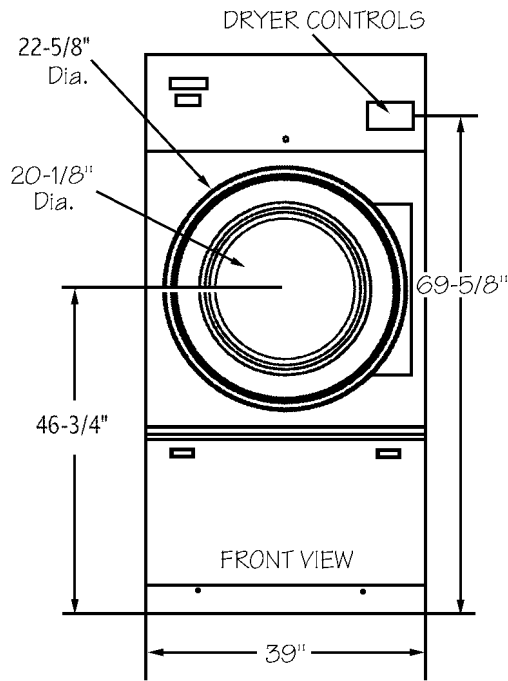
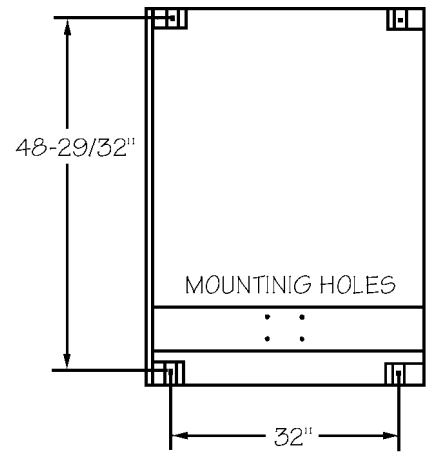

**ALL DIMENSIONS ARE +/- 1/4" (+/- 6.4 mm) AND ARE SUBJECT TO CHANGE WITHOUT NOTICE**

